

THE PRESERVE @ GRAND LAKE

A SUBDIVISION OF DELAWARE COUNTY, OKLAHOMA

PLAT AND DEDICATION OF
THE PRESERVE @ GRAND LAKE
A SUBDIVISION OF DELAWARE COUNTY, OKLAHOMA

KNOW ALL MEN BY THESE PRESENTS: THAT, GREEN COUNTRY SHORELINE, LLC., BEING SOLE OWNER OF THE HEREON PLATTED PROPERTY, DO HEREBY CERTIFY THAT WE HAVE CAUSED SAME TO BE PLATTED INTO LOTS AND EASEMENTS SHOWN WHICH ARE RESERVED BY THE DEDICATORS WHICH WE HEREBY ADOPT AS THE PRESERVE @ GRAND LAKE

DATED THIS 5th DAY OF Feb, 2008

Jim Barbuto
JIM BARBUTO, MANAGING PARTNER

+-2008-001837 Book 1808 Pg. 698
12/20/2008 10:34 am Pg 0893-0707
Fee \$ 25.00 Doc. \$ 0.00
Carol Fortner - Delaware County Clerk
State of Oklahoma



+-2008-001837 Book 1808 Pg. 693
12/20/2008 10:34 am Pg 0893-0707
Fee \$ 25.00 Doc. \$ 0.00
Carol Fortner - Delaware County Clerk
State of Oklahoma

BASIS OF BEARINGS: G.R.D.A. TAKING LINE

NOTES:

- 1.) 5/8" PIN W/ CAP SET AT LOT CORNERS UNLESS OTHERWISE NOTED.
- 2.) LOTS SUBJECT TO FLOWAGE EASEMENT TO ELEVATION 757' N.G.V.D. IN FAVOR OF U.S.C.O.E.
- 3.) THERE IS A 5 FOOT UTILITY EASEMENT ALONG ALL SIDE LOT LINES, UNLESS OTHERWISE NOTED.
- 4.) THERE IS A 15 FOOT UTILITY EASEMENT ALONG ALL FRONT LOT LINES, UNLESS OTHERWISE NOTED.
- 5.) THERE IS A 30 FOOT BUILDING SETBACK ALONG ALL FRONT AND REAR LOT LINES, UNLESS OTHERWISE NOTED.
- 6.) THERE IS A 10 FOOT BUILDING SETBACK ALONG ALL SIDE LOT LINES, UNLESS OTHERWISE NOTED.
- 7.) THERE IS A 15 FOOT NO STRUCTURE EASEMENT AROUND ALL CUL-DE-SACS.

+-2008-001837 Book 1808 Pg. 700
12/20/2008 10:34 am Pg 0893-0707
Fee \$ 25.00 Doc. \$ 0.00
Carol Fortner - Delaware County Clerk
State of Oklahoma

+-2008-001837 Book 1808 Pg. 698
12/20/2008 10:34 am Pg 0893-0707
Fee \$ 25.00 Doc. \$ 0.00
Carol Fortner - Delaware County Clerk
State of Oklahoma

STATE OF OKLAHOMA)
COUNTY OF DELAWARE) SS

I, THE COUNTY TREASURER IN AND FOR DELAWARE COUNTY, STATE OF OKLAHOMA, HEREBY CERTIFY THAT ALL TAXES FOR THE YEAR 08 AND ALL PREVIOUS YEARS HAVE BEEN PAID.

DATED THIS 12 DAY OF Feb, 2008

Mary Jane Law
MARY JANE LAW, DELAWARE COUNTY TREASURER



FLOODPLAIN STATEMENT

"I CERTIFY THAT I HAVE APPROVED THIS PLAT AND HAVE VERIFIED THAT PORTIONS OF THE PROPERTY ALONG THE LAKEFRONT ARE LOCATED WITHIN SFHA ZONE AE" ACCORDING TO DELAWARE COUNTY F.I.R.M. MAP NUMBER 400502 PANEL 1850 AND 1900.

RESTRICTIONS TO APPROVAL: None. except property located in a Designated Flood zone. An Application for Permit will have to be turned into my office. Prior to Building.

DATE: 1-31-08

Robert Real
ROBERT REAL, FLOODPLAIN ADMINISTRATOR

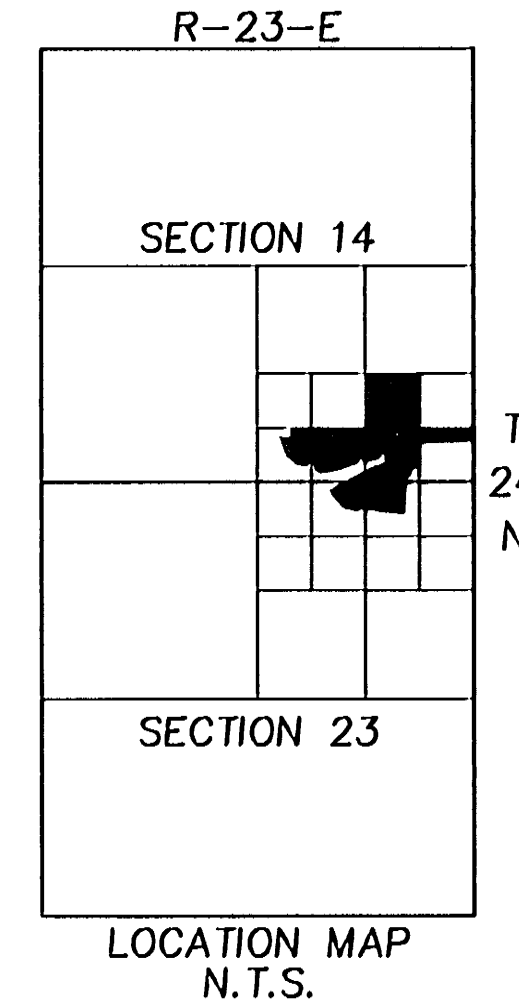

DEPARTMENT OF ENVIRONMENTAL QUALITY

"I CERTIFY THAT I HAVE APPROVED THE APPLICATION AND PLAN FOR A PLAT OF A RESIDENTIAL DEVELOPMENT WHICH IS ON FILE AT DELAWARE COUNTY OFFICE OF THE DEPARTMENT OF ENVIRONMENTAL QUALITY, AND HEREBY APPROVE THIS PLAT FOR THE USE OF GROVE MUNICIPAL SERVICE AUTHORITY WATER SYSTEM AND INDIVIDUAL AEROBIC SEWAGE SYSTEMS."

RESTRICTIONS TO APPROVAL: None

DATE: 1-30-08

Peggy S Poppe
ENVIRONMENTAL SPECIALIST
DEPARTMENT OF ENVIRONMENTAL QUALITY



+-2008-001837 Book 1808 Pg. 697
12/20/2008 10:34 am Pg 0893-0707
Fee \$ 25.00 Doc. \$ 0.00
Carol Fortner - Delaware County Clerk
State of Oklahoma

FOR THE PURPOSE OF PROVIDING AN ORDERLY DEVELOPMENT OF THE PRESERVE @ GRAND LAKE, DO HEREBY PROVIDE RESTRICTIVE COVENANTS FILED IN BOOK 1806, PAGE 461-462, OF RECORDS IN THE OFFICE OF THE COUNTY CLERK, DELAWARE COUNTY, OKLAHOMA.

IN WITNESS WHEREOF, GREEN COUNTRY SHORELINE, LLC., HAVE CAUSED THESE PRESENTS TO BE SIGNED THIS 5th DAY OF February, 2008.

Jim Barbuto
JIM BARBUTO, MANAGING PARTNER

STATE OF OKLAHOMA)
COUNTY OF DELAWARE) SS

THE FOREGOING INSTRUMENT WAS ACKNOWLEDGED BEFORE ME THIS 5th DAY OF FEBRUARY 2008.

Winn Fowler
NOTARY PUBLIC

MY COMMISSION EXPIRES: 09 / 14 / 2008



LAND SURVEYOR'S DECLARATION:

I HEREBY CERTIFY THAT THE HEREON PLATTED AND DESCRIBED SURVEY WAS COMPLETED UNDER MY SUPERVISION AND MEETS THE OKLAHOMA MINIMUM STANDARDS FOR THE PRACTICE OF LAND SURVEYING AS ADOPTED BY THE OKLAHOMA STATE BOARD OF REGISTRATION FOR PROFESSIONAL ENGINEERS AND LAND SURVEYORS.

Rick G. Rose
RICK G. ROSE, P.L.S. #1209

CERTIFICATE OF COUNTY COMMISSIONERS

ROADS WILL NOT BE MAINTAINED BY THE COUNTY. - Roads will be Private.
APPROVED BY THE DELAWARE COUNTY COMMISSIONERS ON THIS 19 DAY OF Feb, 2008.

Kenneth Crowder
KENNETH CROWDER

+-2008-001837 Book 1808 Pg. 699
12/20/2008 10:34 am Pg 0893-0707
Fee \$ 25.00 Doc. \$ 0.00
Carol Fortner - Delaware County Clerk
State of Oklahoma

Dave Kendrick
DAVE KENDRICK

Billy Cornell
BILLY CORNELL

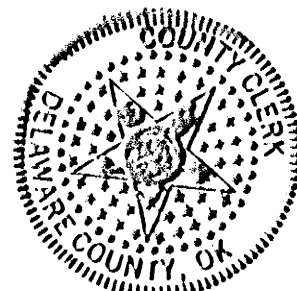

STATE OF OKLAHOMA)
COUNTY OF DELAWARE) SS

I, THE COUNTY CLERK IN AND FOR DELAWARE COUNTY, STATE OF OKLAHOMA, DO HEREBY CERTIFY THAT THE FOREGOING INSTRUMENT IS NOW ON FILE IN MY OFFICE.

DATED THIS 19 DAY OF Feb, 2008

Carol Fortner
CAROL FORTNER, DELAWARE COUNTY CLERK

Rose & McCray, P.C.
2125 South Broadway, Grove, OK 74344
918.786.6350 FAX: 918.786.7536 www.rosemcgray.com

Engineering & Land Surveying

CA 4716 (PE/LS) EXPIRES 6/30/2009

THE PRESERVE @ GRAND LAKE
A SUBDIVISION OF
DELAWARE COUNTY, OKLAHOMA

Revisions

FINAL PLAT	
Drawn by T.HOPKINS	Job Number 07356-01
Checked by R.ROSE	Contact Person R.ROSE
Date JAN2008	Sheet Number 1 of 2

Time: 8:49 am
Date: 1/10/08 (PS)
Date: 1/7/2008
Xrefs Used: 156410X
© 2008 by Rose & McCray, P.C.